

DC Power Connectors

The **CLIFF®** range of DC Power Connectors comprise several different models for chassis mounting and horizontal or vertical PCB mounting. Our products are manufactured to strict quality and performance standards. All plastic parts are minimum UL-94HB for toughness and durability. The standard colour is Black and some models are available with a choice of pin diameters and switched contacts. Typical applications include portable equipment of all types, signal processors, power supplies etc.

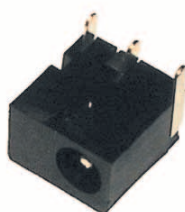

**DC-8 PCB mounting
pin ring type. Rated
12V / 1A. Minature
version for PCB
mounting. 1.3mm
dia. pin.**

DC-8 (FC68145)

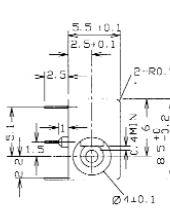
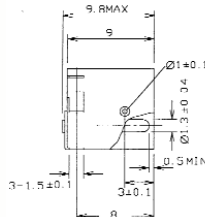

PC LAYOUT

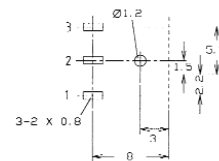

**DC-9 PCB mounting
pin ring type with
switch. Rated 12V /
5A. DC9 with 2.1mm
dia. pin. DC9A with
2.5mm dia. pin.**

DC-9 (FC68146)
DC-9A (FC681461)

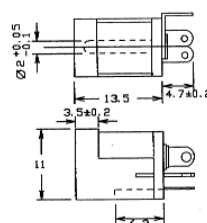
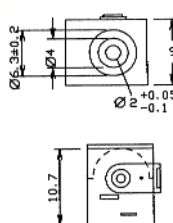

PC LAYOUT

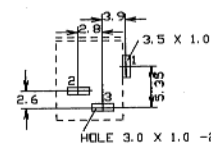

**DC-10 PCB mounting
pin / ring type with
switch. Rated 12V /
5A. DC10A with
2.1mm dia. pin.
DC10B with 2.5mm
dia. pin.**

DC-10A (FC68148)
DC-10B (FC68149)

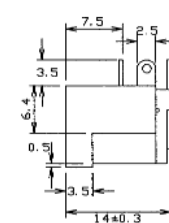
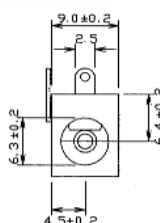

PC LAYOUT

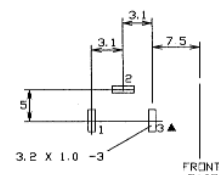

SCD-026 chassis mounting.

**SCD - 026 with
2.1mm dia. pin.
SCD - 026A with
2.5mm dia. pin.**

SCD-026 (FC681445)
SCD-026A (FC681446)

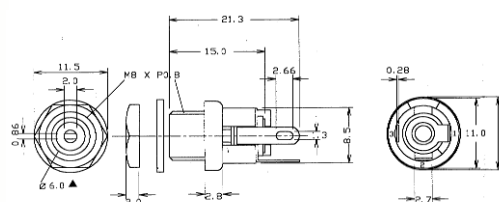

Cliff Electronic Components, Ltd.
76 Holmethorpe Avenue, Holmethorpe Ind. Est.
Redhill, Surrey RH1 2PF, England

Tel: +44 (0) 1737 771375

Fax: +44 (0) 1737 766012

Email: sales@cliffuk.co.uk



Visit us online at:

www.cliffuk.co.uk

DC Power Connectors



**DC-12A PCB
mounting pin / ring
type with switch.
Rated 12V / 5A.
With 2.1mm dia.
pin.**

DC-12A (FC681485)

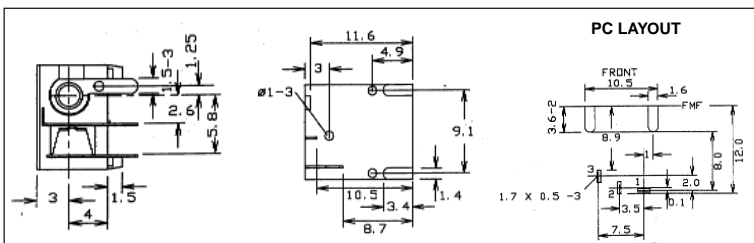

**DC-13 panel
mounting pin / ring
type with switch.
Rated 12V / 5A.
DC-13A with 2.1mm
dia. pin. DC-13B
with 2.5mm dia. pin.
[DC-13A \(FC681492\)](#)
[DC-13B \(FC681493\)](#)**

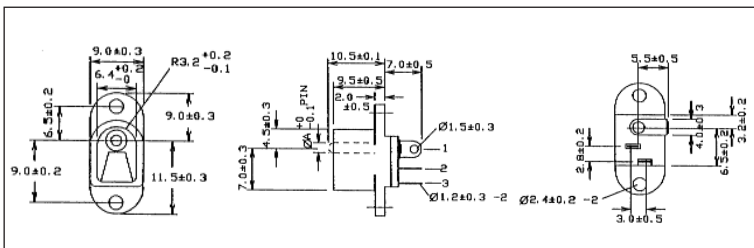

**DCPP1 DC Line
connector. Rated
12V / 5A. DCPP1
with 2.1mm dia. pin.
DCPP2 with 2.5mm
dia. pin.**

DCPP1 (FC68147)
DCPP2 (FC681471)

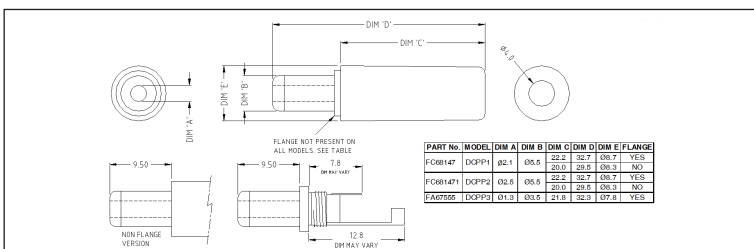

**DCPP3 DC Line
connector. Rated
12V / 5A. With
1.3mm dia. pin**

DCPP3 (FA67555)

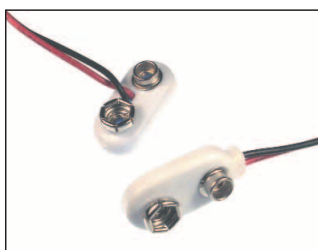
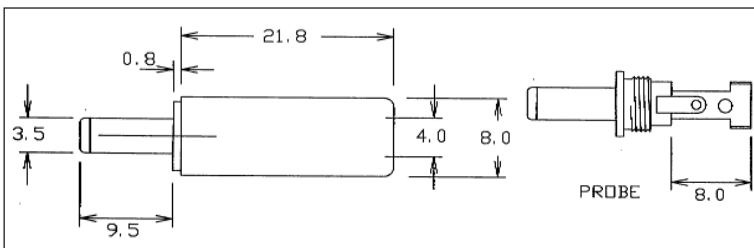

**CCB-1 9V Battery
connector. Cable
length 220mm.
Tough molded body.
CCB-1A 'T' Type
Cable length
220mm.**

CCB-1 (FC6830)
CCB-1A (FC6831)

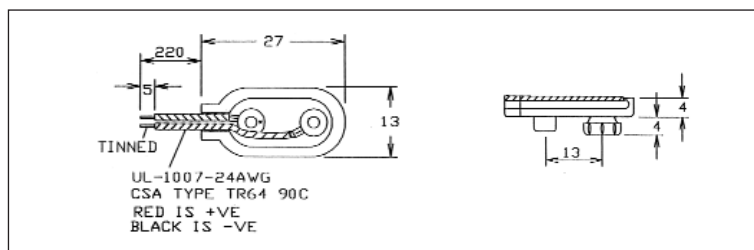

Please note we can also supply DC Plugs moulded onto cable as custom products.