

4840, solder terminal, Socket, 6.3 mm, 2-pole, DC Plug/Socket



### Description

- Solder terminal :  
Screw-on mounting , from rear-side
- Low Voltage DC Plug and Socket
- DC Plug: 2-pole , straight

### Technical Data

|                       |                    |
|-----------------------|--------------------|
| Diameter              | 6.3 mm / 2.0 mm    |
| Number of Poles       | 2-pole             |
| Ratings DC            | 0.5 A / 12 VDC     |
| Dielectric Strength   | 500 VDC            |
| Insulation Resistance | > 100 MΩ @ 500 VDC |

|                           |   |
|---------------------------|---|
| Allowable Operation Temp. | -20 °C to 70 °C                                 |
| Terminal                  | solder terminal silver plated                   |
| Mounting                  | Screw-on mounting<br>wall thickness max. 5.5 mm |
| Style                     | straight  |
| Lifetime                  | 5000 Insertions                                 |

### Dimensions

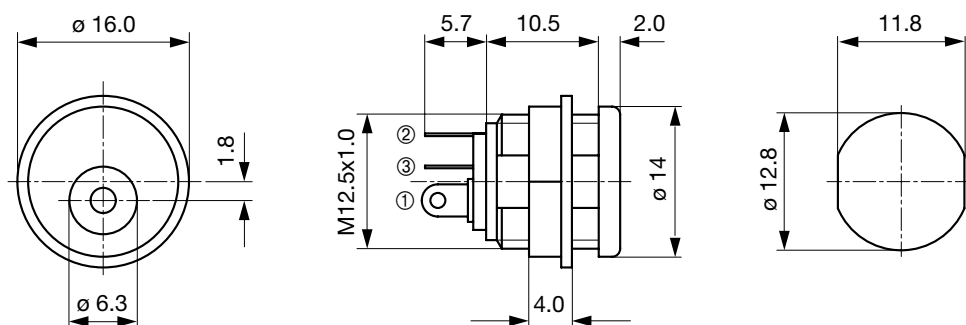

### Diagrams

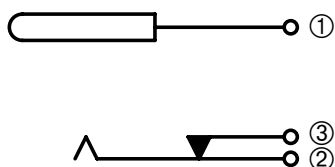

All Variants

| Product group  | Diameter [mm] | Number of Poles | Terminal        | Order Number |
|----------------|---------------|-----------------|-----------------|--------------|
| DC Plug/Socket | 6.3           | 2-pole          | solder terminal | 4840.2200    |

Most Popular.

Availability for all products can be searched real-time:<http://www.schurter.com/Stock-Check/Stock-Check-SCHURTER>

|                |         |
|----------------|---------|
| Packaging unit | 250 Pcs |
|----------------|---------|

Mating Inlets/Plugs

Category / Description

[DC Plug/Socket Overview complete](#)



|   |           |
|---|-----------|
| 4840, solder terminal, Plug, 5.5 mm, 2-pole, DC Plug/Socket | 4840.1200 |
| 4840, Cable, Plug, 5.5 mm, 2-pole, DC Plug/Socket           | 4840.5200 |
| 4840, Cable, Plug, 5.5 mm, 2-pole, DC Plug/Socket           | 4840.5201 |

[DC Plug/Socket further types to 4840.2200](#)