

# 1.27mm pitch Pin Header

## - SMT - low profile dual row

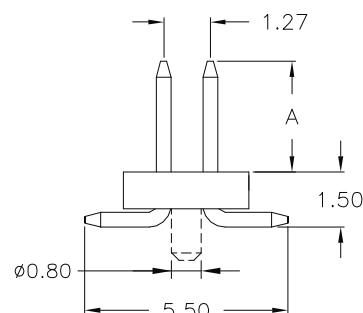
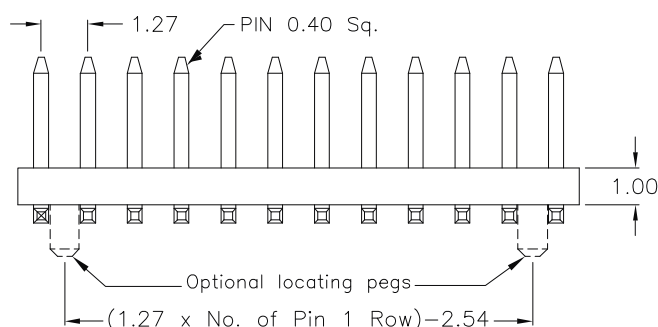
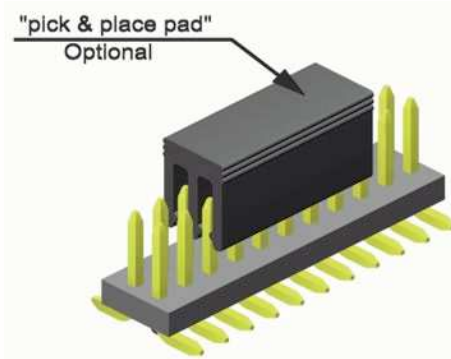
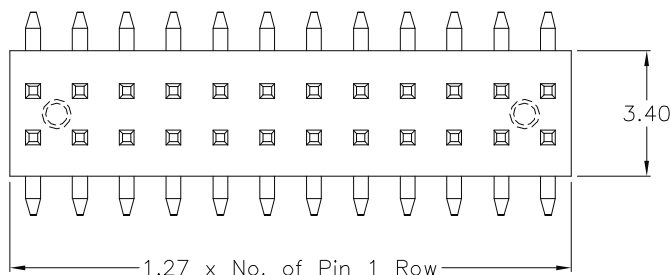

### APPLICATION AND FEATURES

- **Standard:** *tube packing and without "locating pegs"*
- Assures reliable PC Board connections
- Low profile insulator
- Mates with 1.27mm pitch Female Headers

### PCB Surface Mount Layout

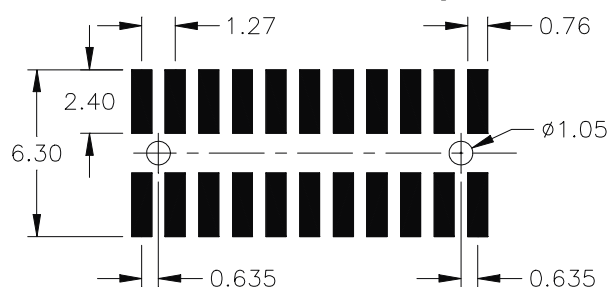

### SPECIFICATIONS

Current rating 1 A  
Insulator resistance 1000 MΩ min.  
Withstanding voltage 500 V AC

Operating temperature - 40°C to +105°C  
Processing temperature +250°C +0/-5°C for 10sec.  
Contact material (RoHS compliant) Copper alloy  
Insulator material (RoHS compliant) Nylon UL 94 V-0

### How to order

SS2 - xxx - H xx/x - 55 /11 X

Nbr of pins	Pin code	DIM "A"	Plating	Packing and "pick & place pad" Option
without locating pegs: <b>006 to 100</b>	<b>70/0</b>	3.00 mm	<b>55</b> = gold	<b>without "locating pegs"</b>
	<b>70/1</b>	10.00 mm		<b>A</b> = tube packing; with pick & place pad
	<b>70/2</b>	6.50 mm		<b>B</b> = reel packing; with pick & place pad
with locating pegs: <b>008 to 100</b>	Other dimensions on request		Other platings on request	<b>with "locating pegs"</b> (available only from 008 to 100 pins)
				<b>C</b> = tube packing; without pick & place pad
				<b>D</b> = tube packing; with pick & place pad
				<b>E</b> = reel packing; with pick & place pad