



# HITPOINT

TEL:8862-26013311

FAX:8862-26013898

NO.4 Lane 505, Zhongzheng Rd., Linkou Shiang, Taipei, Taiwan 24445 . R.O.C

## Piezo Electric Sounder PT-3110P-05Q

(RoHS)

DATE:2009.05.11

### 1 . Electrical Characteristics

VER.:3

Resonant Frequency (KHz)	1.1 ±0.5
Operating Voltage (Vp-p/max)	30
Rated Voltage (Vp-p)	5.0
Current Consumption (mA/max)	2.0 at Rated Voltage
Sound Pressure Level (dB/min)	80 at 10cm at Rated Voltage
Capacitance (pF)	48,000 ± 30% at 120 Hz
Operating Temperature (°C)	-20 ~ +90
Storage Temperature (°C)	-30 ~ +100
Condition by wave (°C)	260±5°C / within 5sec
Condition by hand (°C)	350±20°C / within 5sec

PS : Vp-p = 1/2 duty , square wave

### 2 . Typical Frequency Response Curve

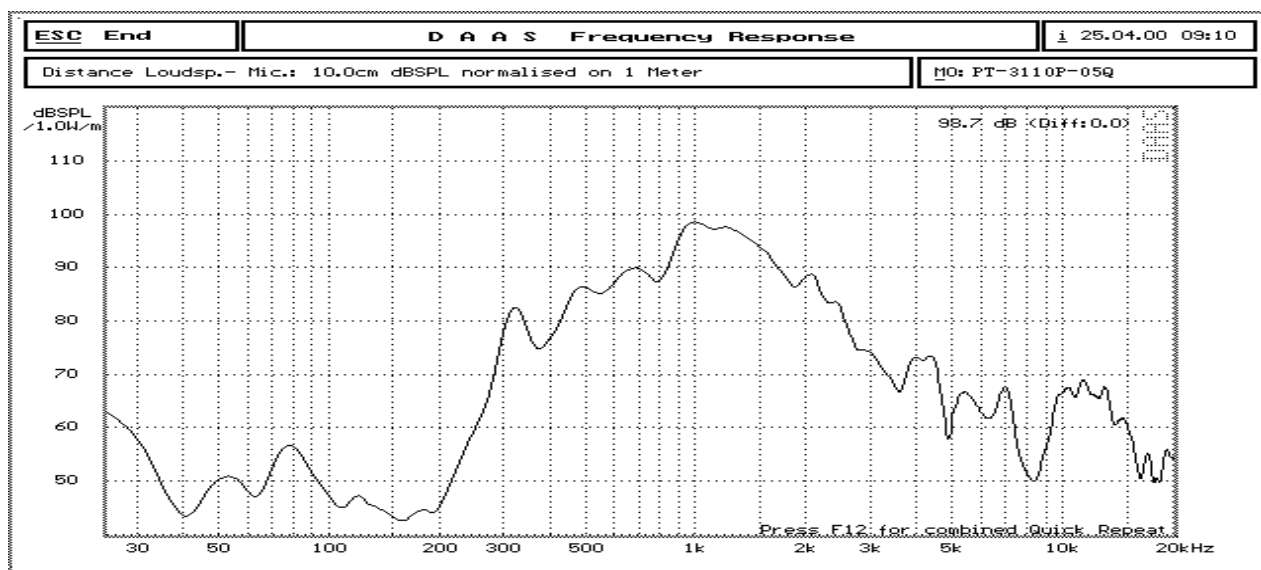



# HITPOINT

TEL:8862-26013311

FAX:8862-26013898

NO.4 Lane 505, Zhongzheng Rd., Linkou Shiang, Taipei, Taiwan 24445 . R.O.C

### 3 . Dimensions and Material

#### 3-1 Shape

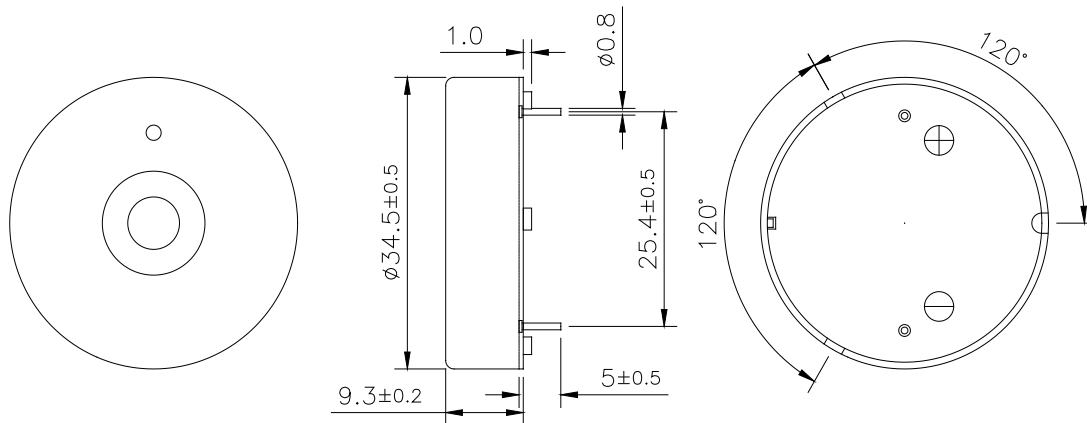

Unit : mm

#### 3-2 Material

Housing	ABS 777D UL94HB plastic resin (Color : Black)
Leading Pin	Tin Plated Brass
Weight (Gram)	4.2



# HITPOINT

TEL:8862-26013311  
FAX:8862-26013898

NO.4 Lane 505, Zhongzheng Rd., Linkou Shiang, Taipei, Taiwan 24445 . R.O.C

## 4. TESTING METHOD

### • *Standard Measurement conditions*

Temperature:  $25 \pm 2^\circ\text{C}$  Humidity: 45-60%

### • *Acoustic Characteristics*

The oscillation frequency, current consumption and sound pressure are measured by the measuring instruments shown below.

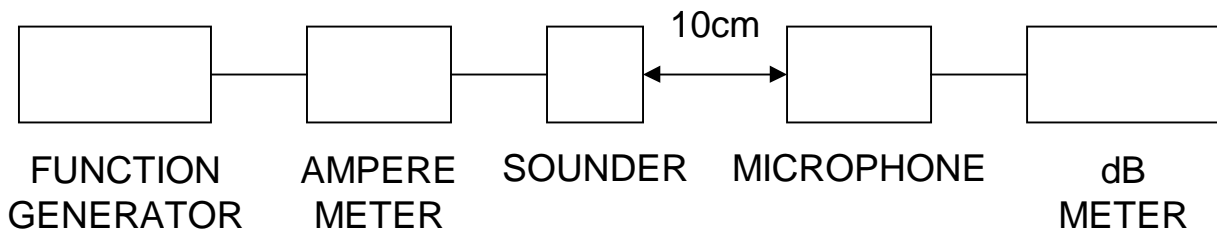

## 5. RELIABILITY

ITEMS	METHOD OF TEST AND MEASUREMENTS	PERFORMANCE
Coldness withstanding	After 98 hours of being exposed to $-30^\circ\text{C}$ environment, should be returned to normal environment for 2 hours, then re-proceed to test.	No abnormality shall exist
Hotness withstanding	After 98 hours of being exposed to $+100^\circ\text{C}$ environment, should be returned to normal environment for 2 hours, then re-proceed to test.	No abnormality shall exist
Humidity withstanding	After 98 hours of being exposed to $40^\circ\text{C}$ 95%RH environment in actual operation, should be returned to normal environment for 2 hours, then re-proceed to test.	No abnormality shall exist
Durability	Testing after 1,000 hours actual continuous operation. (at standard measurement conditions)	No abnormality shall exist
Drop withstanding	A natural drop from 75cm high down to the ground.	No abnormality shall exist
Vibration withstanding	Vibration of 2,000 cycles per minute, 2mm amplitude, applied in X, Y and Z directions for 30 minutes each.	No abnormality shall exist



# HITPOINT

TEL:8862-26013311

FAX:8862-26013898

NO.4 Lane 505, Zhongzheng Rd,. Linkou Shiang,Taipei, Taiwan 24445 . R.O.C

## **6. PACKAGE METHOD**

<1> 120pcs per box , Total 10 boxes per carton , total 1200pcs carton;

Volume: L\*W\*H=520\*335\*290mm

<2>N . W . : ; 8KGS ; G . W . : 9KGS ;

<3>RoHS Mark