

TMM

TMM Series
1.27mm pitch

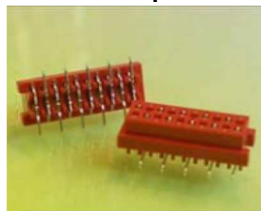

X

-X

-XX

-X

Type

1=IDC Male
2=IDC Transition Plug
3=DIP Male Straight
4=DIP Female Straight
5=DIP Female R/A
6=SMT Female Straight

Locking

L= with Lock
0= w/o Lock

No. of Positions

04= 04 Positions
:
:
26= 26 Positions

Packaging

1= Tape&Reel+cap
2= Tube
3= Bag
4= Tape&Reel w/o cap

TMM-6-0

(SMT Female ST)

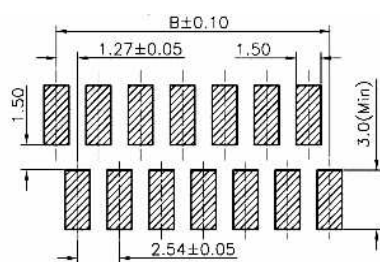
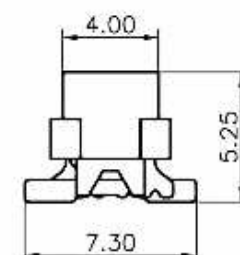
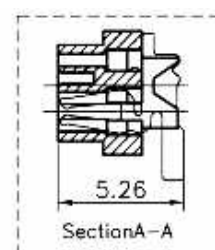
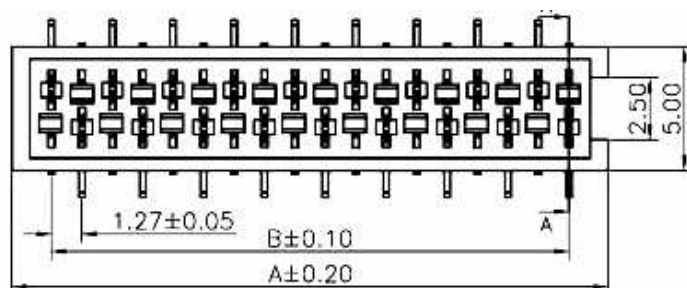

PCB Layout

Pos	A	B	C	Pos	A	B	C
4	7.00	3.81	5.60	16	22.24	19.05	20.84
6	9.54	6.35	8.14	18	24.78	21.59	23.38
8	12.08	8.89	10.68	20	27.32	24.13	25.92
10	14.62	11.43	13.22	22	29.86	26.67	28.46
12	17.16	13.97	15.76	24	32.40	29.21	31.00
14	19.70	16.51	18.30	26	34.94	31.75	33.54

General Specification

Materials and Finish :

Insulator: Glass-reinforce thermo plastic, UL 94V-0, Nylon, Color in Red
Contact : Phosphor Bronze, Tin plated.

Electrical :

Contact Resistance: 20 mΩ max. at 1A DC
Insulation Resistance: 1000 MΩ min, at 500 V/DC.
Dielectric Withstanding Voltage : 500 V AC/RMS 60Hz for one minute.
Current Rating : 1.5 A max
Voltage Rating : 230V AC/RMS 60Hz, DC

Environment :

Operating Temperature:
-40 degree C to +105 degree C